

# SUBLINE350/350U/W

**BLANCO**



**Model Code**  
SUBLINE350/350U/W

**Description**  
Double bowl configuration

**Accessories**  
Optional Accessories:  
SUBLINEBK  
SUBLINECOLSS

**Warranty**  
30 year warranty



## Features

## Benefits

Engineered in Germany

Elegant SILGRANIT™ design impresses with its timeless, straight lined bowl geometry which will suit all types of kitchen products and worktops.

Durability

SILGRANIT™ PuraDur™ II consists of 80% granite, which makes it unbeatably resilient, extremely durable, scratch proof, heat resistant, unbreakable and acid resistant.

Hygiene + Plus™

A patented formula that acts as a shield against dirt and bacteria. This hygiene protection reduces bacteria growth by an average of 98%.

Maximum Bowl Size

Due to the smallest possible radii of 10mm it allows for a large sink area and a modern classy look.

Designer wastes

No additional costs after purchase

Rear waste position

Increases your storage space below the sink

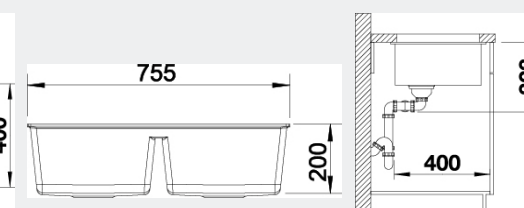
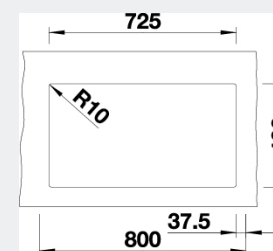
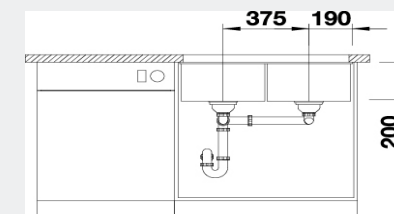
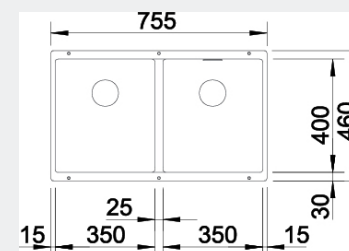

Method of Installation:	Undermount
Overall Dimensions:	755w x 460d x 200/200hmm
Cut-out Dimensions:	725w x 400d
Colour:	Available in Anthracite or White
Corner Radius:	10mm
Bowl Capacities:	26 Litres
Standard Inclusion:	Designer Wastes
Integrated Overflow:	Yes
Warranty:	30 years

Note: Measurements are within 2/3mm of factory tolerance. It is advisable to check dimensions of physical product when measuring for installations and before doing any cut outs.

\*Due to continual product development the information provided is not final and may be subject to change.